

Overpressure Blast Valve

Type A 1803

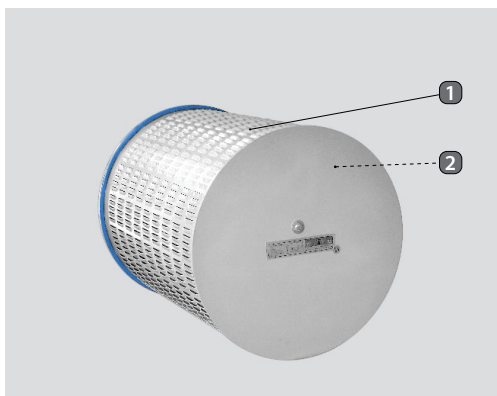

Description

The Overpressure Blast Valve Type **A 1803** is designed to release air from the shelter while maintaining a constant overpressure and also to protect against explosive and implosive blast waves. The valve is normally closed. It is maintenance-free and withstands heat and corrosion. The springs are manufactured from special stainless steel and all steel parts are phosphate treated and finished with a powder coating.

Overview

The Overpressure Blast Valve Type **A 1803** is a valve used to stop explosive blast waves from entering a bomb shelter as well as to regulate the air pressure in the shelter. The valve is tested and certified to the Israeli Standard 4570 by the Civil Defence Command and the Standards Institution of Israel.

Illustration:

1. Protective Housing
2. Closing Device

PRODUCT USE:

- Installed on an 8" flange according to BS 4504 – PN 6 or DIN 2501 – PN 6
- Should be installed only with equipment that has been manufactured by Beth-El Industries to ensure maximum performance



CERTIFICATIONS:

- Tested and certified for compliance to the applicable Israeli, Singaporean, and Swiss Standards
- Quality control according to ISO 9001
- Quality assurance AQAP 2110

Approximate Dimensions:

all dimensions are in mm

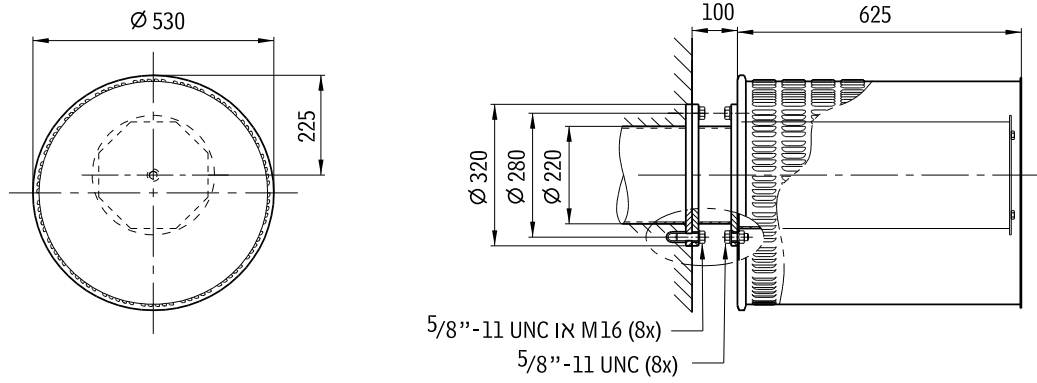

Pressure Drop on Airflow A 1803:

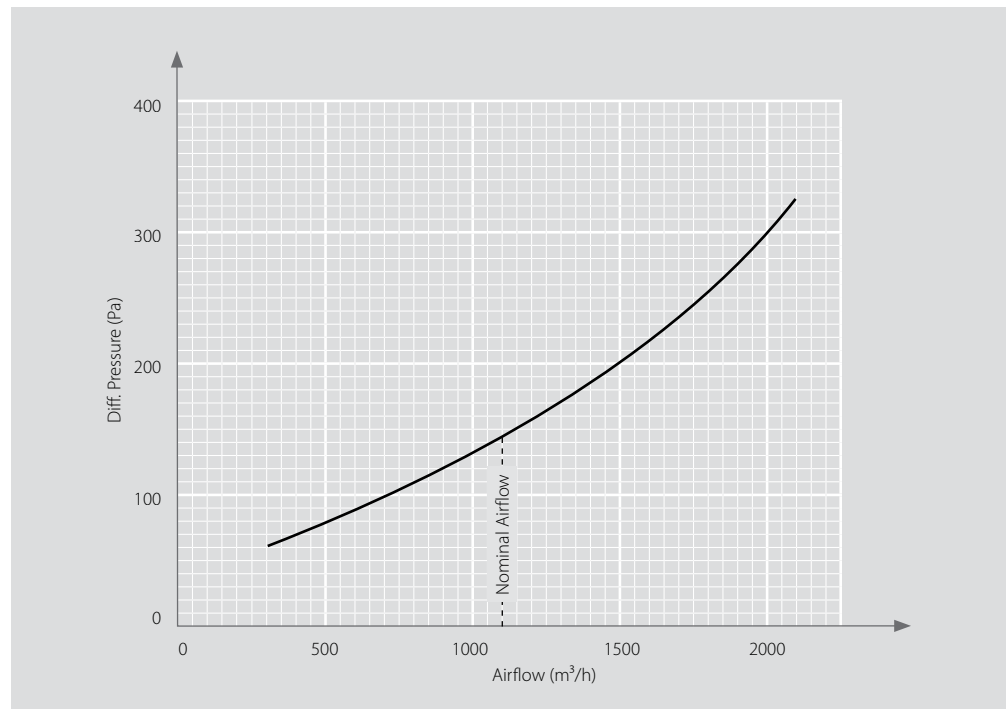

Specifications for the A 1803:

Product No:	B10740	
Airflow Rate:	500-2000 (300-1180)	m³/h (cfm)
Flow Resistance:	See Diagram	
Incident Pressure Durability:	300 (42)	kPa (psi)
Reflected Pressure Durability:	1100 (154)	kPa (psi)
Working Temperature:	-25 to +55 (-13 to +131)	°C (°F)
Mechanical Shock Resistance:	20	g

Specifications are subject to change without prior notice.

Beth-El Industries Ltd.

1 Avshalom Road
Zikhron Yaaqov, Israel
Tel: + 972-4-629 9999
www.beind.com